

PROJECT BY



**PRUTHVI**  
GROUP  
CONSTRUCTION WITH COMMITMENT



**PRUTHVI**  
GROUP

CONSTRUCTION WITH COMMITMENT

**CORPORATE OFFICE:**

Pruthvi Group,  
Office No. 1 & 2, Parmar CHS Ltd.,  
Paranjape B Scheme Road No. 1,  
Vile Parle (E), Mumbai - 400 057. INDIA.

**SITE ADDRESS:**

Pruthvi Pushpanjali, Shahaji Raje Marg,  
Vile Parle (E), Mumbai - 400 057. INDIA.

**TEL.:**

+91 22 2618 0796  
+91 22 2610 0796

**MOB.:**

+91 91672 39292

info@pruthvigroup.co

pruthvigroup.co

MahaRERA Registration No. P51800046070  
<https://maharera.mahaonline.gov.in>

DISCLAIMER: This brochure and its images are purely conceptual and not legal offering to its recipient by the promoter/developer nor will it be a part of any binding agreement. All units are unfurnished, and furnishing, fixtures, furniture shown are for aesthetic representation purpose only and are not a part of the flat/unit offered for sale.





PRUTHVI  
**PUSHPANJALI**  
*Inspired by all generations...*

**THE LATEST RESIDENTIAL  
DEVELOPMENT IN VILE PARLE  
FROM THE HOUSE OF  
PRUTHVI GROUP**



# WING A

## TYPICAL FLOOR PLAN - 1st to 8th



Unit	Configuration	Rera Carpet Area
1	2 BHK	756 SQ.FT.
2	2 BHK	749 SQ.FT.
3	2 BHK	755 SQ.FT.
4	2 BHK	756 SQ.FT.

Disclaimer - Plans are subject to change as may be approved by MCGM from time to time. Furniture & fixtures shown are just for representation purpose only.

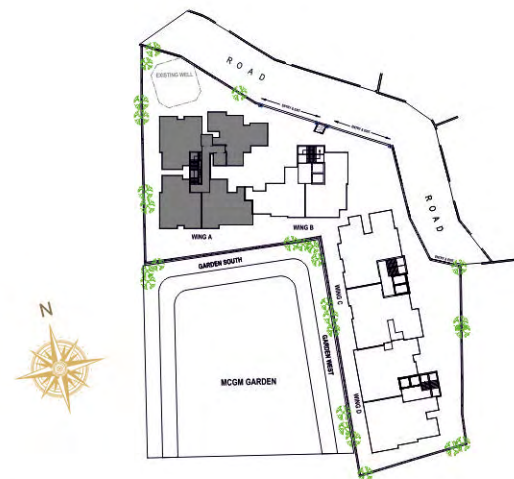

# WING A

## TYPICAL FLOOR PLAN - 7th to 8th



Unit	Configuration	Rera Carpet Area
1	2 BHK	756 SQ.FT.
2	2 BHK	749 SQ.FT.
3	4.5 BHK	1520 SQ.FT.

Disclaimer - Plans are subject to change as may be approved by MCGM from time to time. Furniture & fixtures shown are just for representation purpose only.

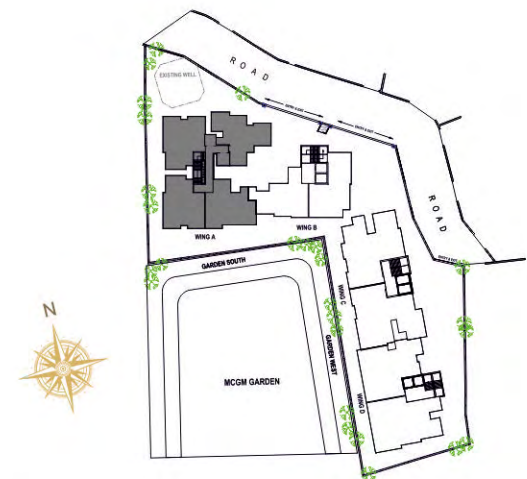

# WING B

## TYPICAL FLOOR PLAN - 1st to 5th



Unit	Configuration	Rera Carpet Area
1	2 BHK	751 SQ.FT.
2	2.5 BHK	819 SQ.FT.



Disclaimer - Plans are subject to change as may be approved by MCGM from time to time. Furniture & fixtures shown are just for representation purpose only.

# WING B

## 6th FLOOR PLAN



Unit	Configuration	Rera Carpet Area
1	3 BHK	989 SQ.FT.
2	2.5 BHK	831 SQ.FT.

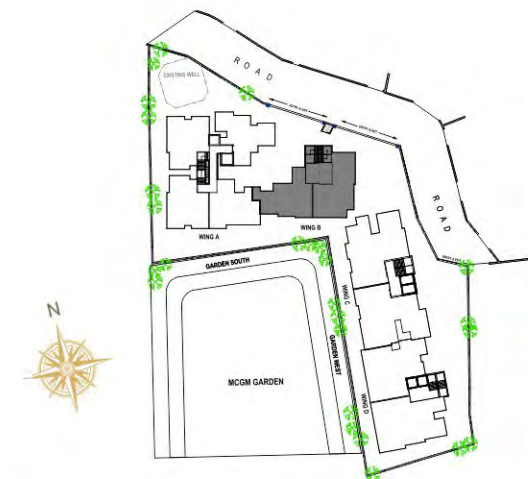

Disclaimer - Plans are subject to change as may be approved by MCGM from time to time. Furniture & fixtures shown are just for representation purpose only.

# WING B

## TYPICAL FLOOR PLAN - 7th to 8th



Unit	Configuration	Rera Carpet Area
1	3 BHK	989 SQ.FT.
2	2.5 BHK	831 SQ.FT.

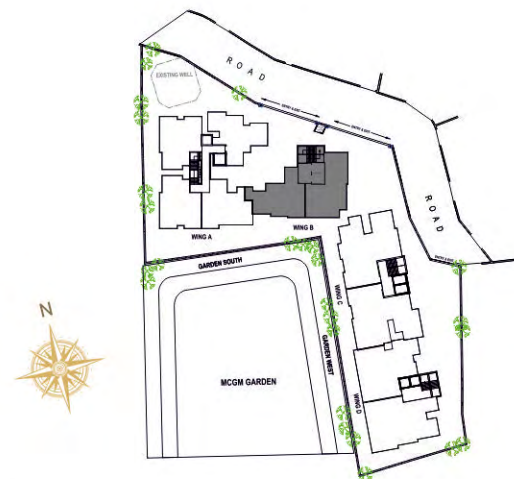

Disclaimer - Plans are subject to change as may be approved by MCGM from time to time. Furniture & fixtures shown are just for representation purpose only.

# WING B

## TYPICAL FLOOR PLAN - 7th to 8th (Option-2)



Unit	Configuration	Rera Carpet Area
1	5 BHK	1829 SQ.FT.

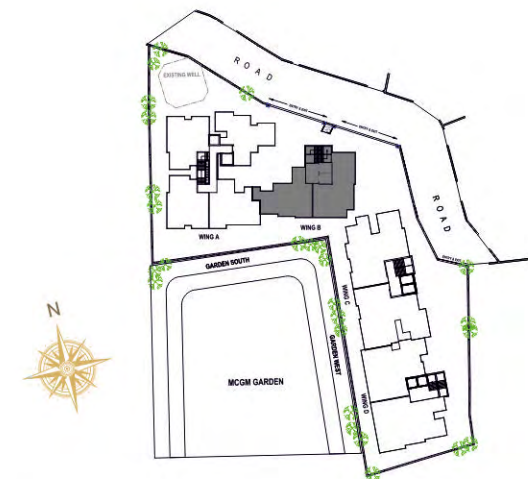

Disclaimer - Plans are subject to change as may be approved by MCGM from time to time. Furniture & fixtures shown are just for representation purpose only.

# WING C

## 1st FLOOR PLAN



Unit	Configuration	Rera Carpet Area
1	2 BHK	812 SQ.FT.
2	3 BHK	1057 SQ.FT.



Disclaimer - Plans are subject to change as may be approved by MCGM from time to time. Furniture & fixtures shown are just for representation purpose only.



# WING C

## TYPICAL FLOOR PLAN - 2nd & 3rd



Unit	Configuration	Rera Carpet Area
1	3 BHK	1060 SQ.FT.
2	3 BHK	1057 SQ.FT.



Disclaimer - Plans are subject to change as may be approved by MCGM from time to time. Furniture & fixtures shown are just for representation purpose only.



# WING C

## TYPICAL FLOOR PLAN - 4th & 5th



Unit	Configuration	Rera Carpet Area
1	2 BHK	857 SQ.FT.
2	3 BHK	1057 SQ.FT.
3	1 BHK	464 SQ.FT.

Disclaimer - Plans are subject to change as may be approved by MCGM from time to time. Furniture & fixtures shown are just for representation purpose only.



# WING C

## 6th FLOOR PLAN



Unit	Configuration	Rera Carpet Area
1	2 BHK	857 SQ.FT.
2	2 BHK	852 SQ.FT.
3	1 BHK	464 SQ.FT.
4	1 BHK	464 SQ.FT.

Disclaimer - Plans are subject to change as may be approved by MCGM from time to time. Furniture & fixtures shown are just for representation purpose only.



# WING C

## 6th FLOOR PLAN (Option 2)



Unit	Configuration	Rera Carpet Area
1	3.5 BHK	1326 SQ.FT.
2	3.5 BHK	1323 SQ.FT.

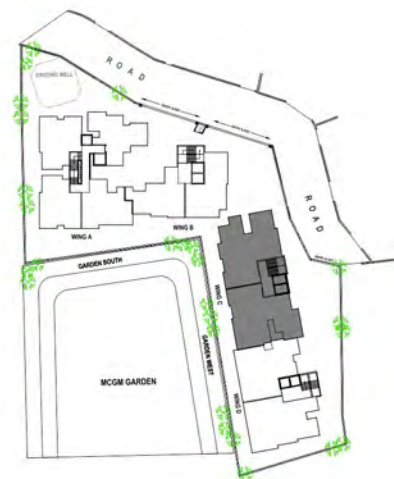

Disclaimer - Plans are subject to change as may be approved by MCGM from time to time. Furniture & fixtures shown are just for representation purpose only.



PRUTHVI  
PUSHPANJALI  
*Inspired by all generations...*

# WING D

## 6th FLOOR PLAN



Unit	Configuration	Rera Carpet Area
1	3 BHK	1148 SQ.FT.
2	3 BHK	1248 SQ.FT.

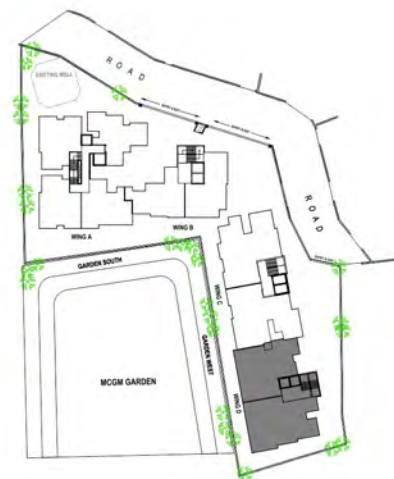

Disclaimer - Plans are subject to change as may be approved by MCGM from time to time. Furniture & fixtures shown are just for representation purpose only.



PRUTHVI  
PUSHPANJALI  
*Inspired by all generations...*